

ZEB COVE

PLANNING BOARD APPROVAL
DATE: 6/23/16
BY: [Signature]

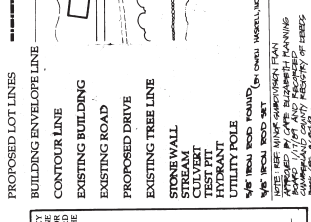

LEGEND

CERTIFY THAT OUR SURVEY WORK CONFORMS TO THE MAINE LAND SURVEYS ACT AND THE STANDARD PRACTICES OF THE PROFESSION. NO WRITTEN REPORT IS REQUIRED.



AMENDED
SITE PLAN
MINOR SUBDIVISION
HIDDEN COURT
Cape Elizabeth, Maine

Landmark Architect
Terrence A. Landmark
106 Maine Street
Yarmouth, Maine
04089

Owner/Subdivider
A. & C. H. Robinson
14 Borrowing Drive
Cumberland Forestele, Maine
04111

SCALE: 1" = 100'
0 50 100 150 200

DECEMBER 2, 1988
REVISED DECEMBER 30, 1988

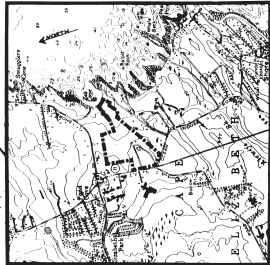

LOCATION MAP
SCALE: 1:2500
DEPARTMENT OF THE INTERIOR
GEOLOGICAL SURVEY

- 1. The purpose of this plan is to serve as a visual aid in the review of proposed changes to the Stone House and the Garden House Lot. The proposed changes are shown on this plan for convenience of recording purposes.
- 2. All proposed changes and acreage additions to this plan are approximate and should be confirmed by a professional.
- 3. Proposed acreage changes to the Garden House Lot and the Stone House Lot are as follows:
 - Lot A to be taken from Garden House Lot and added to Stone House Lot = 15,000 sq. ft. +/-
 - Lot B to be taken from Garden House Lot and added to Stone House Lot = 17,750 sq. ft. +/-
 - Lot C to be taken from Stone House Lot and added to Garden House Lot = 17,750 sq. ft. +/-
- 4. New proposed acreage of Stone House Lot = 42 acres +/-
- 5. New proposed acreage of Garden House Lot = 14 acres +/-

LOT 2 - 10.0 ACRES
Field House

LOT 1 - 42+ ACRES
Stone House

LOT 3 - 10.0 ACRES
Garden House

LOT 4 - 80,076 sf
Gate House

PERMETER SURVEY INFORMATION FOR ADJACENT LOTS:
NORTH: BASKIN BROS. INC.
EAST: HASKELL, INC.
WEST: HASKELL, INC.
SOUTH: PORTLAND, MAINE



PROPERTY MAPS
TOWN OF CAPE ELIZABETH, MAINE



James H. Thomas
gisSolutions of Maine
Cumberland, Maine
jht@maine.rr.com

These maps are intended to be used for the purpose of Property Tax Assessments and should not be used for conveyances.
Revised to April 1, 2012

Scale: 1 inch = 200



2012
MAP: R02-1

